

09/08/99
 15-OCT-2014 09:13
 O:\RDY\DOONE\PENDER\ER-2971_3603.3.28-Atkinson_Sidewalk_05132014\ROADWAY\Proj\Plan_Sheets\ER-2971_3603.3.28-Rdy_tsh.dgn
 jwg/les AT DSCAD281685

TIP PROJECT: ER-2971
CONTRACT: DC00083

STATE OF NORTH CAROLINA
 DIVISION OF HIGHWAYS

PENDER COUNTY

STATE	STATE PROJECT REFERENCE NO.	SHEET NO.	TOTAL SHEETS
N.C.	ER-2971	1	
STATE PROJ. NO.	F.A. PROJ. NO.	DESCRIPTION	
3603.3.28	0005-424		

**LOCATION: NC 53 (CHURCH ST.) FROM STRINGFIELD ST. (NON-SYSTEM)
 TO BEATTYS BRIDGE RD. (NON-SYSTEM) IN THE TOWN OF ATKINSON.**

TYPE OF WORK: INSTALL CONCRETE SIDEWALK AND CURB RAMPS

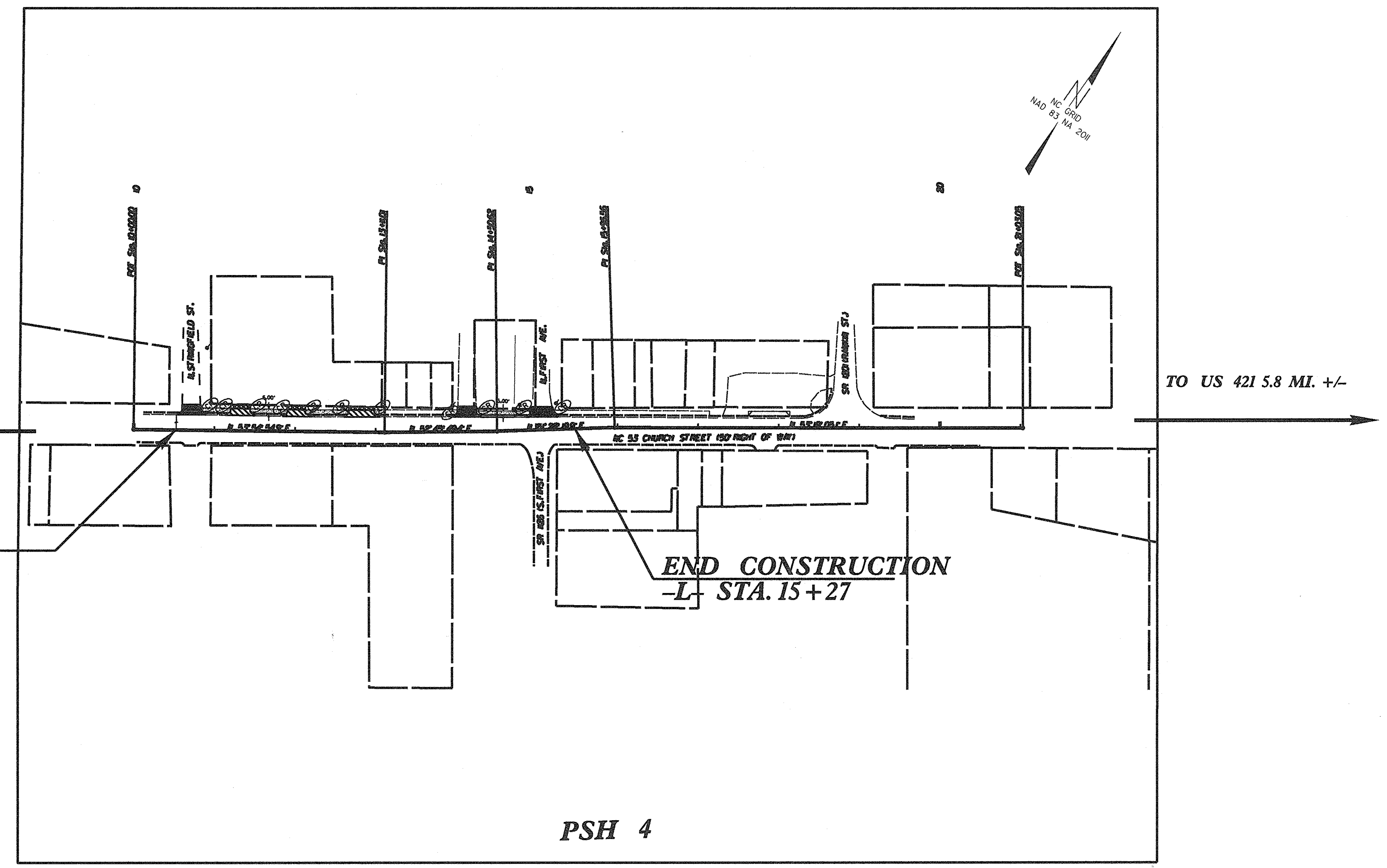
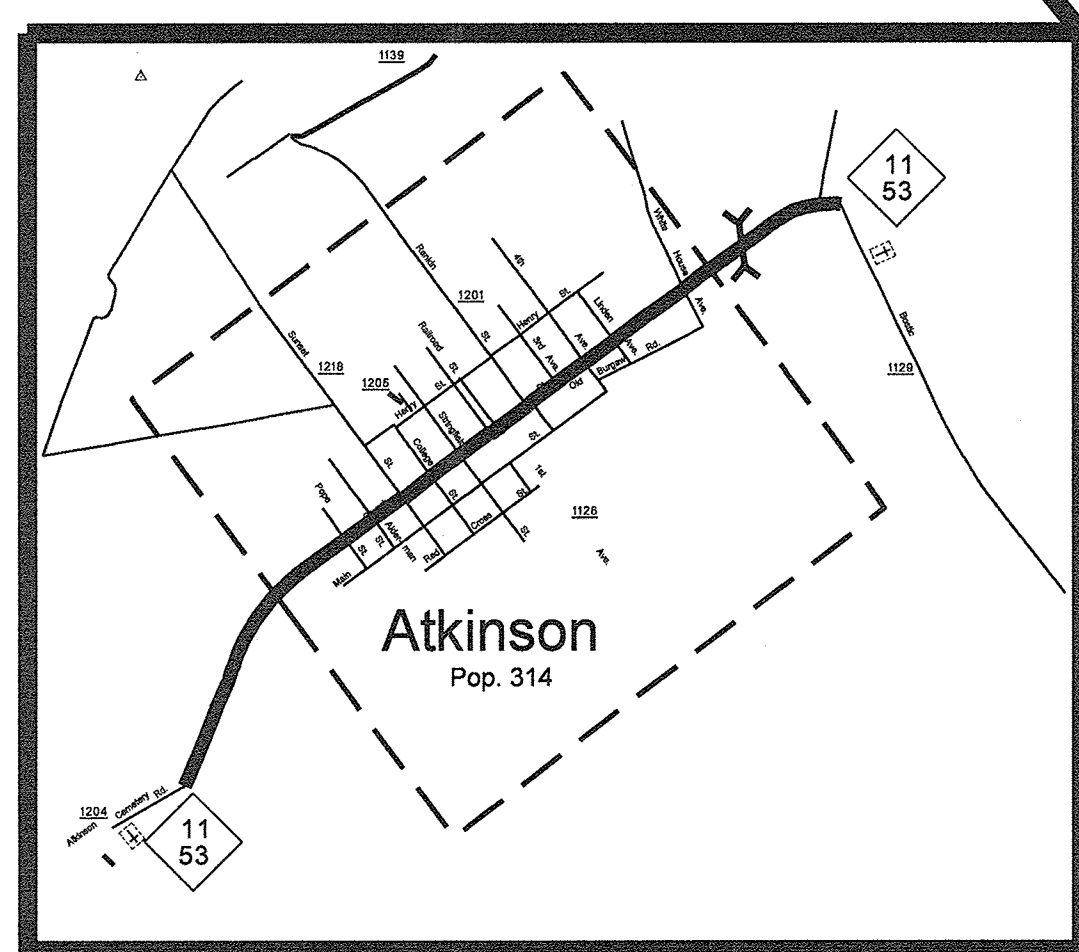

NOT TO SCALE

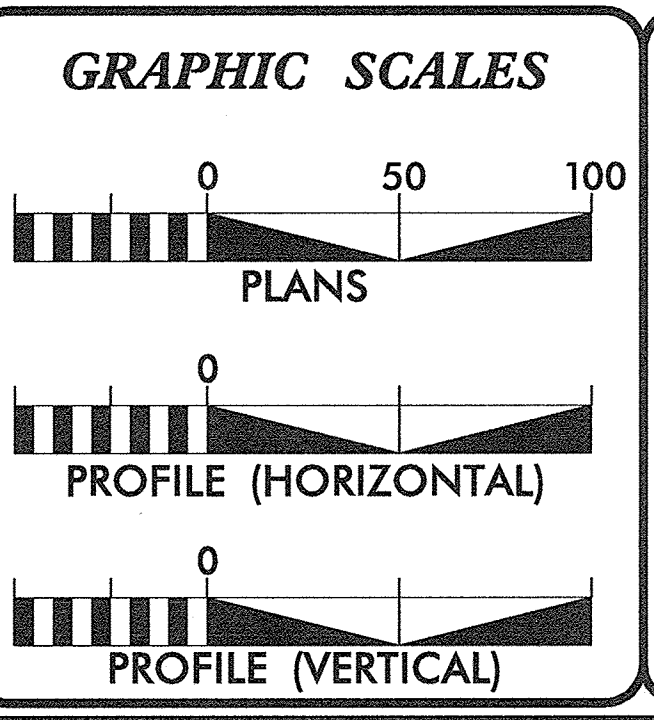

DESIGN DATA

 N/A

PROJECT LENGTH

 -L- (NC 53) = 0.09 MI

Prepared in the Office of:
DIVISION OF HIGHWAYS
 5501 BARBADOS BLVD., CASTLE HAYNE, NC, 28429

2012 STANDARD SPECIFICATIONS RIGHT OF WAY DATE: LETTING DATE: November 20, 2014	DAVID LEONARD, PE PROJECT ENGINEER JON W. GILES JR. PROJECT DESIGN TECHNICIAN
--	--

SIGNATURE: _____

10-15-14
 P.E.

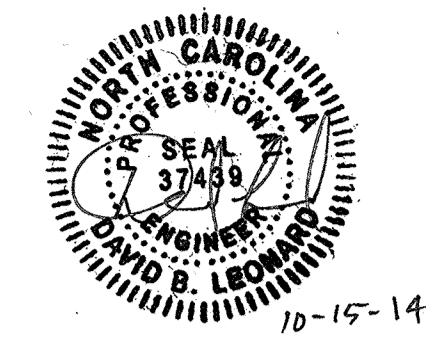

GENERAL NOTES:

2012 SPECIFICATIONS
EFFECTIVE: 01-17-12
REVISED: 07/30/12

SIDE ROADS:

THE CONTRACTOR WILL BE REQUIRED TO DO ALL NECESSARY WORK TO PROVIDE SUITABLE CONNECTIONS WITH ALL ROADS, STREETS, AND DRIVES ENTERING THIS PROJECT. THIS WORK WILL BE PAID FOR AT THE CONTRACT UNIT PRICE FOR THE PARTICULAR ITEMS INVOLVED.

DRIVEWAYS:

DRIVEWAYS SHALL BE CONSTRUCTED IN ACCORDANCE WITH STD. 848.02 USING 3' RADII OR RADII AS SHOWN ON THE PLANS. LOCATIONS OF DRIVES WILL BE AS SHOWN ON THE PLANS OR AS DIRECTED BY THE ENGINEER.

DRIVEWAYS SHALL BE CONSTRUCTED IN ACCORDANCE WITH STD. 848.03 AT LOCATIONS SHOWN ON PLANS OR AS DIRECTED BY THE ENGINEER.

STREET TURNOUT:

STREET RETURNS SHALL BE CONSTRUCTED IN ACCORDANCE WITH STD. NO. 848.04 USING THE RADII NOTED ON PLANS.

SUBSURFACE PLANS:

NO SUBSURFACE PLANS ARE AVAILABLE ON THIS PROJECT. THE CONTRACTOR SHOULD MAKE HIS OWN INVESTIGATION AS TO THE SUBSURFACE CONDITIONS.

CURB RAMPS

CURB RAMPS ARE SHOWN ON THE PLANS AT APPROXIMATE LOCATIONS.

INDEX OF SHEETS

SHEET NUMBER	SHEET
1	TITLE SHEET, ALIGNMENT AND SHEET LAYOUT
1-A	INDEX OF SHEETS, GENERAL NOTES AND LIST OF STANDARD DRAWINGS
1-B	CONVENTIONAL SYMBOLS
1-D	ALIGNMENT DESCRIPTION SHEET
2 THRU 2-B	PAVEMENT SCHEDULE, TYPICAL SECTIONS AND PROJECT DETAILS
4	PLAN SHEETS

2012 ROADWAY ENGLISH STANDARD DRAWINGS

The following Roadway Standards as appear in "Roadway Standard Drawings" Highway Design Branch - N. C. Department of Transportation - Raleigh, N. C., Dated January, 2012 are applicable to this project and by reference hereby are considered a part of these plans:

STD.NO.	TITLE
DIVISION 6 - ASPHALT BASES AND PAVEMENTS	
654.01	Pavement Repairs
DIVISION 8 - INCIDENTALS	
846.01	Concrete Curb, Gutter and Curb & Gutter
848.01	Concrete Sidewalk
848.03	Driveway Turnout - Drop Curb Type
848.05	Curb Ramp - Proposed Curb & Gutter
848.06	Curb Ramp - Existing Curb & Gutter

8/17/99
 08-OCT-2014 12:13
 C:\CROD\509\PROJECTS\2014\ROADWAY\Proj\Plan_Sheets\ER-2971\3603.3.28_Rdy_1A.dgn
 05132014\ROADWAY\Proj\Plan_Sheets\ER-2971\3603.3.28_Rdy_1A.dgn
 08-OCT-2014 12:13
 C:\CROD\509\PROJECTS\2014\ROADWAY\Proj\Plan_Sheets\ER-2971\3603.3.28_Rdy_1A.dgn

STATE OF NORTH CAROLINA
DIVISION OF HIGHWAYS

CONVENTIONAL PLAN SHEET SYMBOLS

Note: Not to Scale

*S.U.E. = Subsurface Utility Engineering

BOUNDARIES AND PROPERTY:

State Line	-----
County Line	-----
Township Line	-----
City Line	-----
Reservation Line	-----
Property Line	-----
Existing Iron Pin	○ _{EP}
Property Corner	-----
Property Monument	□ _{ECM}
Parcel/Sequence Number	②③
Existing Fence Line	-x-x-x-
Proposed Woven Wire Fence	○
Proposed Chain Link Fence	□
Proposed Barbed Wire Fence	◇
Existing Wetland Boundary	-WLB-
Proposed Wetland Boundary	-WLB-
Existing Endangered Animal Boundary	-EAB-
Existing Endangered Plant Boundary	-EPB-
Known Soil Contamination: Area or Site	☒ ☒
Potential Soil Contamination: Area or Site	☒ ☒

BUILDINGS AND OTHER CULTURE:

Gas Pump Vent or U/G Tank Cap	○
Sign	○ _S
Well	○ _W
Small Mine	⋈
Foundation	□
Area Outline	□
Cemetery	□ _†
Building	□
School	□ _†
Church	□ _†
Dam	-----

HYDROLOGY:

Stream or Body of Water	-----
Hydro, Pool or Reservoir	□
Jurisdictional Stream	----- _{JS}
Buffer Zone 1	----- _{BZ 1}
Buffer Zone 2	----- _{BZ 2}
Flow Arrow	←
Disappearing Stream	-----
Spring	○
Wetland	-----
Proposed Lateral, Tail, Head Ditch	-----
False Sump	-----

RAILROADS:

Standard Gauge	-----
RR Signal Milepost	○ _{MILEPOST 35}
Switch	SWITCH
RR Abandoned	-----
RR Dismantled	-----

RIGHT OF WAY:

Baseline Control Point	◆
Existing Right of Way Marker	△
Existing Right of Way Line	-----
Proposed Right of Way Line	-----
Proposed Right of Way Line with Iron Pin and Cap Marker	-----
Proposed Right of Way Line with Concrete or Granite R/W Marker	-----
Proposed Control of Access Line with Concrete C/A Marker	-----
Existing Control of Access	-----
Proposed Control of Access	-----
Existing Easement Line	-----
Proposed Temporary Construction Easement	-----
Proposed Temporary Drainage Easement	-----
Proposed Permanent Drainage Easement	-----
Proposed Permanent Drainage / Utility Easement	-----
Proposed Permanent Utility Easement	-----
Proposed Temporary Utility Easement	-----
Proposed Aerial Utility Easement	-----

ROADS AND RELATED FEATURES:

Proposed Permanent Easement with Iron Pin and Cap Marker	-----
Existing Edge of Pavement	-----
Existing Curb	-----
Proposed Slope Stakes Cut	----- _C
Proposed Slope Stakes Fill	----- _F
Proposed Curb Ramp	----- _{CR}
Existing Metal Guardrail	-----
Proposed Guardrail	-----
Existing Cable Guiderail	-----
Proposed Cable Guiderail	-----
Equality Symbol	⊕
Pavement Removal	-----

VEGETATION:

Single Tree	○
Single Shrub	○
Hedge	-----
Woods Line	-----

Orchard	-----
Vineyard	-----

EXISTING STRUCTURES:

MAJOR:	
Bridge, Tunnel or Box Culvert	----- _{CONC}
Bridge Wing Wall, Head Wall and End Wall	----- _{CONC WW}
MINOR:	
Head and End Wall	----- _{CONC HW}
Pipe Culvert	-----
Footbridge	-----
Drainage Box: Catch Basin, DI or JB	□ _{CB}
Paved Ditch Gutter	-----
Storm Sewer Manhole	○ _S
Storm Sewer	----- _S

UTILITIES:

POWER:	
Existing Power Pole	○
Proposed Power Pole	○
Existing Joint Use Pole	○
Proposed Joint Use Pole	○
Power Manhole	○
Power Line Tower	□
Power Transformer	□
U/G Power Cable Hand Hole	○
H-Frame Pole	○
Recorded U/G Power Line	----- _P
Designated U/G Power Line (S.U.E.*)	----- _P

TELEPHONE:

Existing Telephone Pole	○
Proposed Telephone Pole	○
Telephone Manhole	○
Telephone Booth	□
Telephone Pedestal	□
Telephone Cell Tower	○
U/G Telephone Cable Hand Hole	○
Recorded U/G Telephone Cable	----- _T
Designated U/G Telephone Cable (S.U.E.*)	----- _T
Recorded U/G Telephone Conduit	----- _{TC}
Designated U/G Telephone Conduit (S.U.E.*)	----- _{TC}
Recorded U/G Fiber Optics Cable	----- _{T FO}
Designated U/G Fiber Optics Cable (S.U.E.*)	----- _{T FO}

WATER:

Water Manhole	○
Water Meter	○
Water Valve	○
Water Hydrant	○
Recorded U/G Water Line	-----
Designated U/G Water Line (S.U.E.*)	-----
Above Ground Water Line	----- _{A/G Water}

TV:

TV Satellite Dish	⋈
TV Pedestal	□
TV Tower	⊗
U/G TV Cable Hand Hole	□ _{TVH}
Recorded U/G TV Cable	----- _{TV}
Designated U/G TV Cable (S.U.E.*)	----- _{TV}
Recorded U/G Fiber Optic Cable	----- _{TV FO}
Designated U/G Fiber Optic Cable (S.U.E.*)	----- _{TV FO}

GAS:

Gas Valve	◇
Gas Meter	◇
Recorded U/G Gas Line	----- _G
Designated U/G Gas Line (S.U.E.*)	----- _G
Above Ground Gas Line	----- _{A/G Gas}

SANITARY SEWER:

Sanitary Sewer Manhole	⊕
Sanitary Sewer Cleanout	⊕
U/G Sanitary Sewer Line	----- _{SS}
Above Ground Sanitary Sewer	----- _{A/G Sanitary Sewer}
Recorded SS Forced Main Line	----- _{FSS}
Designated SS Forced Main Line (S.U.E.*)	----- _{FSS}

MISCELLANEOUS:

Utility Pole	○
Utility Pole with Base	□
Utility Located Object	○
Utility Traffic Signal Box	□
Utility Unknown U/G Line	----- _{TUTL}
U/G Tank; Water, Gas, Oil	□
Underground Storage Tank, Approx. Loc.	□ _{UST}
A/G Tank; Water, Gas, Oil	□
Geoenvironmental Boring	⊕
U/G Test Hole (S.U.E.*)	⊕
Abandoned According to Utility Records	AATUR
End of Information	E.O.I.

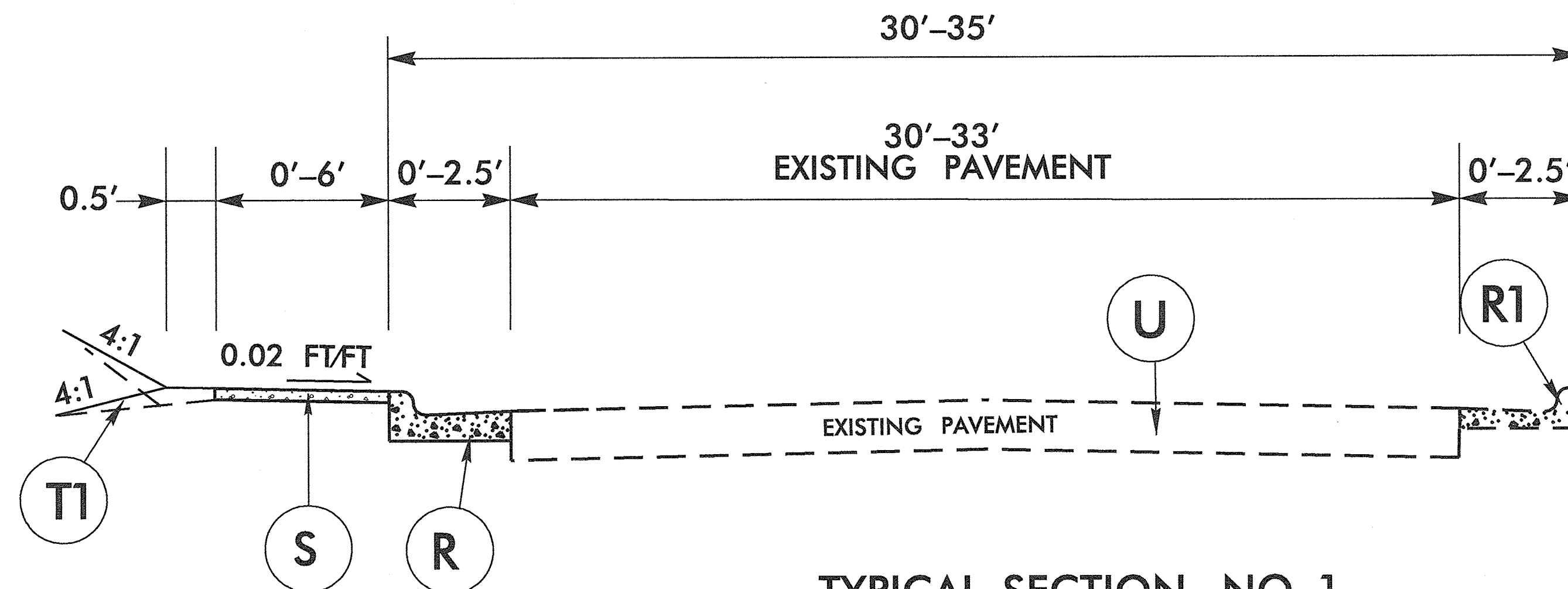
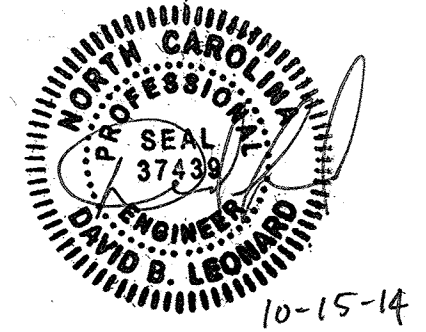

TYPICAL SECTION NO. 1
NC 53 (CHURCH ST)
-L- STA. 10+82.50 TO 19+28.06

PAVEMENT SCHEDULE	
R	PROPOSED CONCRETE 2'-6" CURB & GUTTER
R1	EXISTING CONCRETE 2'-6" CURB & GUTTER
S	PROPOSED CONCRETE SIDEWALK
T1	EARTH MATERIAL
U	EXISTING PAVEMENT

NOT TO SCALE

U:\PROJECTS\2014\1458\BENDER\ER-2971_3603.3.28_Atkins.dwg - Sidewalk - 05/13/2014\ROADWAY\Proj\Plan_Sheets\ER-2971_3603.3.28_Rdy_tjy.dgn
 9/17/13

DIVISION OF HIGHWAYS
STATE OF NORTH CAROLINA

SOIL STABILIZATION TIMEFRAMES

<i>SITE DESCRIPTION</i>	<i>STABILIZATION TIME</i>	<i>TIMEFRAME EXCEPTIONS</i>
PERIMETER DIKES, SWALES, DITCHES AND SLOPES	7 DAYS	NONE
HIGH QUALITY WATER (HQW) ZONES	7 DAYS	NONE
SLOPES STEEPER THAN 3:1	7 DAYS	IF SLOPES ARE 10' OR LESS IN LENGTH AND ARE NOT STEEPER THAN 2:1, 14 DAYS ARE ALLOWED.
SLOPES 3:1 OR FLATTER	14 DAYS	7 DAYS FOR SLOPES GREATER THAN 50' IN LENGTH.
ALL OTHER AREAS WITH SLOPES FLATTER THAN 4:1	14 DAYS	NONE, EXCEPT FOR PERIMETERS AND HQW ZONES.

DETAIL FOR ASPHALT REPAIR
TIE-INS ON SIDE STREETS (NON-SYSTEM)
(SEE STANDARD DRAWING 654.01 PAVEMENT
REPAIR)

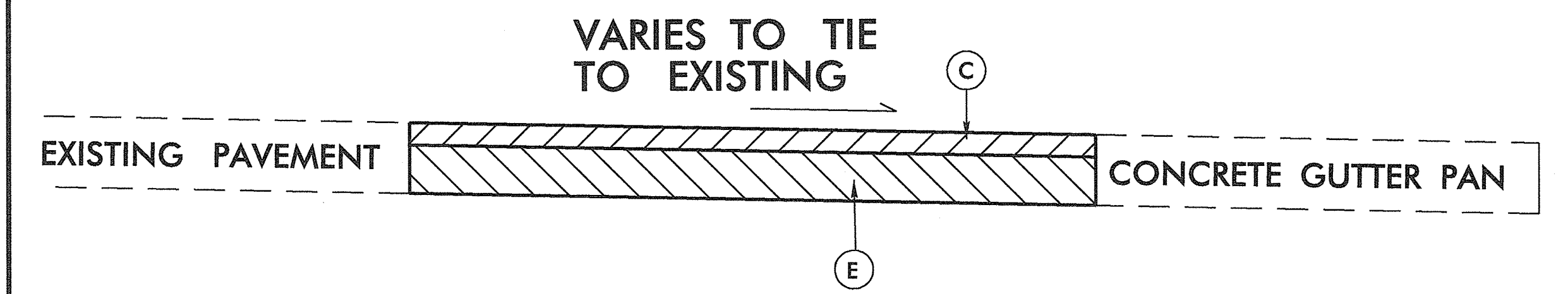

CROSS SECTION
NTS

PAVEMENT SCHEDULE	
C	PROP. APPROX. 2" DEPTH ASPHALT CONCRETE SURFACE COURSE, TYPE S9.6B, AT AN AVERAGE RATE OF 224 LBS. PER SQ.YD.
E	PROP. APPROX. 5½" DEPTH ASPHALT CONCRETE BASE COURSE, TYPE B25.0B, AT AN AVERAGE RATE OF 627 LBS. PER SQ.YD.

DETAIL FOR ASPHALT PAVEMENT REMOVAL ON
SIDE STREETS (NON-SYSTEM) (SEE STANDARD
DRAWING 654.01 PAVEMENT REPAIR)

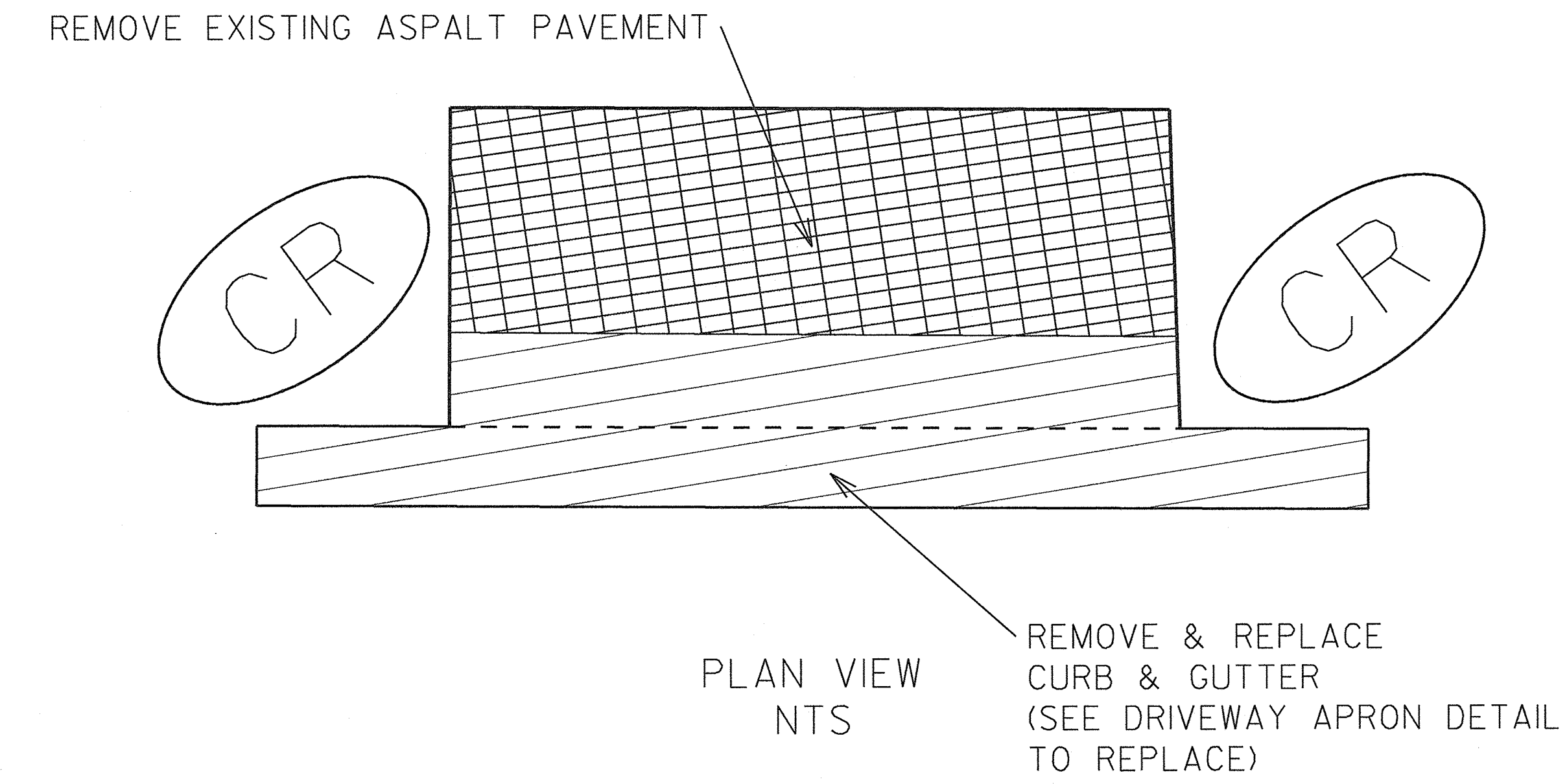

- ① 8.33% (12:1) MAX RAMP SLOPE
- ② CROSS SLOPE: 2.00%
- ④ 8.00% MAX CHANGE IN GRADE BETWEEN ROAD SURFACE AND DRIVEWAY

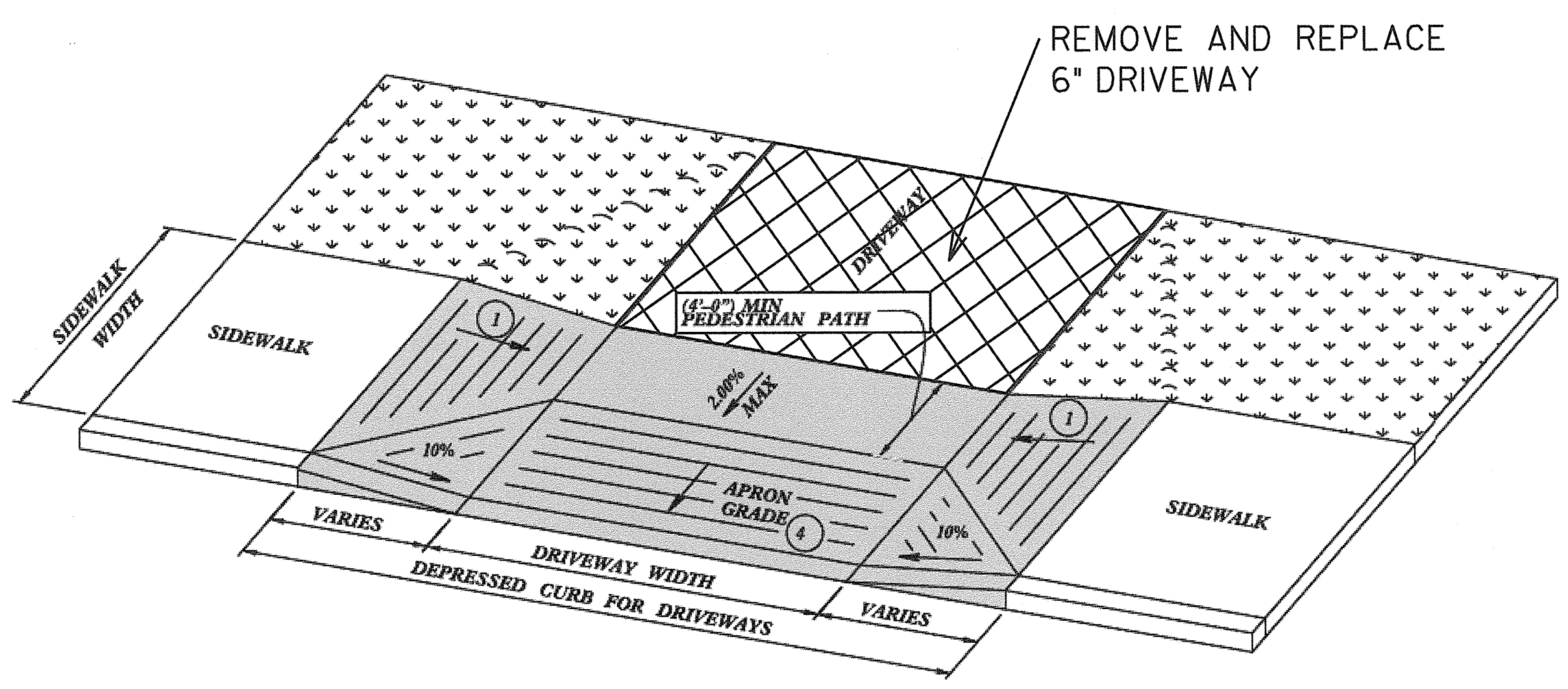

■ PAY LIMITS FOR 1 CURB RAMP

-SEE ROADWAY DETAIL DRAWING 848.05 FOR DETECTABLE WARNING SURFACE AND FOR RAMP NOTES.
-SEE ROADWAY STANDARD DRAWING 848.02 FOR CONCRETE DRIVEWAYS.

DRIVEWAY APRON
NTS

REVISIONS

8/17/99

5:00 PM 8/17/99 14:18 BENDER\ER-2971_3603.3.28_Atkinson_Sidewalk_05132014\ROADWAY\Proj\Plan_Sheets\ER-2971_Rdy_sidewalk_detail_sheet_2-B.dgn
 5:00 PM 8/17/99 14:18 BENDER\ER-2971_3603.3.28_Atkinson_Sidewalk_05132014\ROADWAY\Proj\Plan_Sheets\ER-2971_Rdy_sidewalk_detail_sheet_2-B.dgn

DETAIL FOR PEDESTRIAN SAFETY RAIL

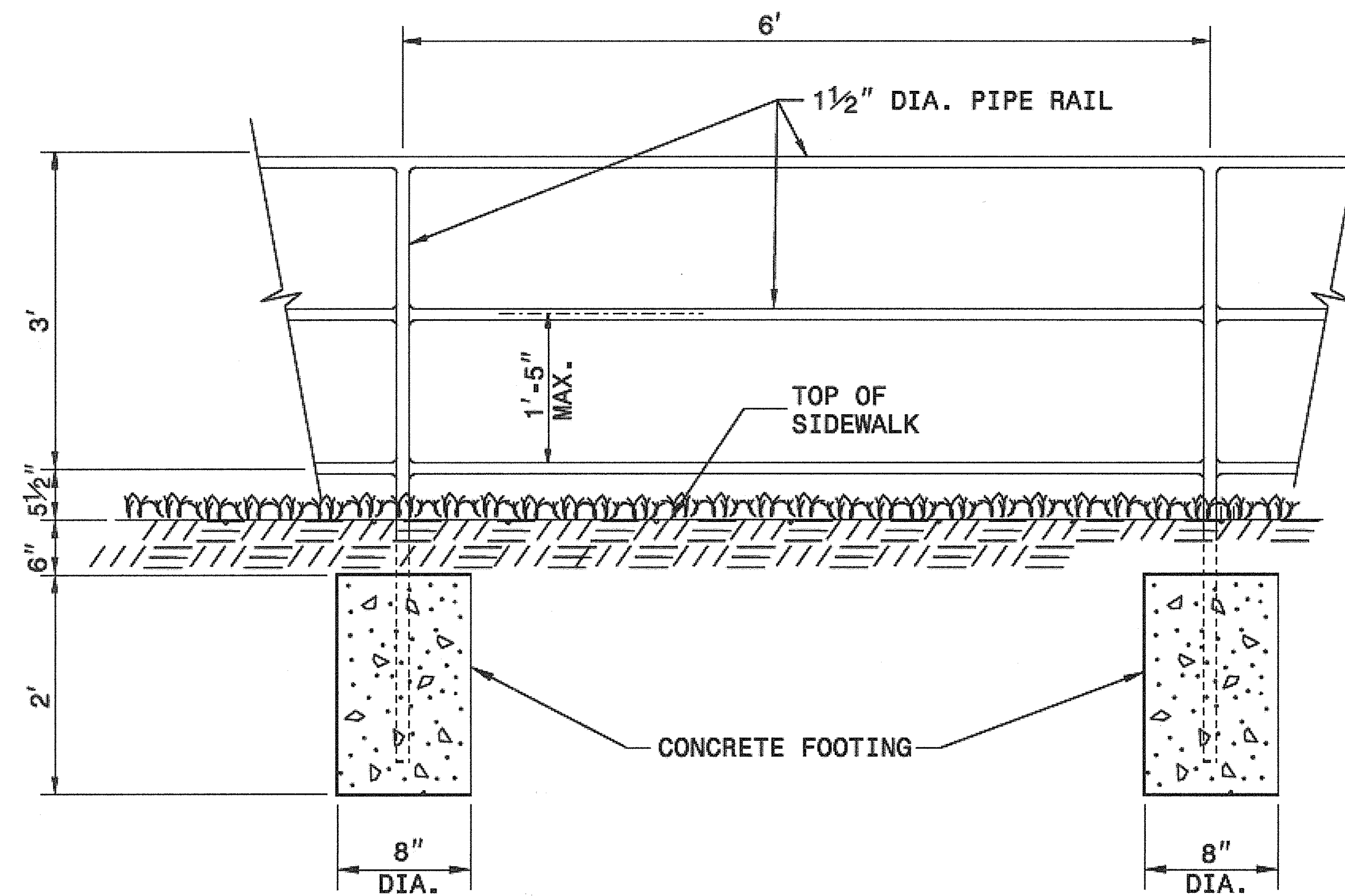

ELEVATION OF PROPOSED PEDESTRIAN HANDRAIL

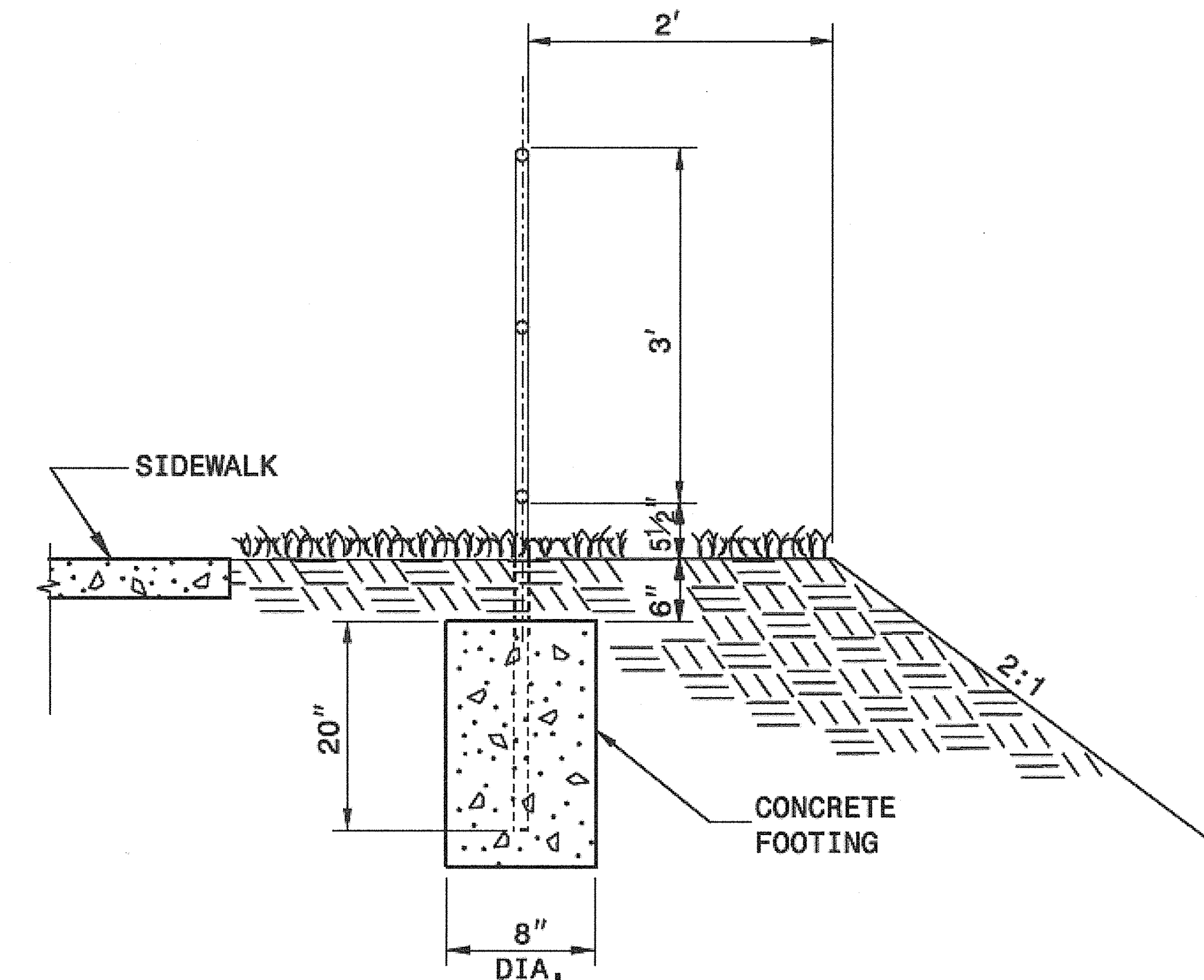

SECTION VIEW

NOTES:

CONSTRUCT PROPOSED STEEL PIPE RAIL OF 1 1/2" DIAMETER SCHEDULE 40 PLAIN END GALVANIZED STEEL PIPE MEETING THE REQUIREMENTS OF ASTM A53.

REPAIR GALVANIZING IN ACCORDANCE WITH SECTION 1076 OF THE NCDOT STANDARD SPECIFICATIONS.

PAINT, IF REQUIRED BY THE ENGINEER, IN ACCORDANCE WITH SECTION 1080 OF THE STANDARD SPECIFICATIONS.

WELD IN ACCORDANCE WITH ARTICLE 1072-20 OF THE STANDARD SPECIFICATIONS.

USE CLASS 'B' CONCRETE FOR HANDRAIL FOOTINGS.

PLACEMENT OF HANDRAIL IN RELATION TO SHOULDER BREAK POINT AND SIDEWALK MAY BE MODIFIED AS DIRECTED BY THE ENGINEER.

REVISIONS

8/17/99
08-067-2014 (2)8
C:\ROY\DOE\BENDER\ER-2971\3603.3.28-Atkins\sn...Sidewalk_05132014\ROADWAY\Proj\Plan_Sheets\ER-2971-Rdy_sidewalk_detail_sheet_2-C.dgn
Wolles AT 03:40:26



NOTE: THIS MAP WAS CREATED FROM AN AERIAL PHOTO. NO LOCATION SURVEYING WAS PERFORMED IN CREATION OF THIS MAP. SPOT LOCATION SURVEYING MAY BE PERFORMED AT A LATER DATE AS NEEDED.

NOTE: PROPERTY BOUNDRIES BY COUNTY TAX MAP. NOT INTENDED AS A PROPERTY SURVEY.

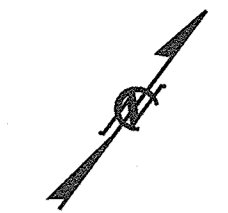

REVISIONS

15-001-2014 12-16-14 UNDER-2971-3603.3.28-Atkinson Sidewalk.dwg 15-001-2014 12-16-14 UNDER-2971-3603.3.28-ASW.PSH.dgn 8/17/19

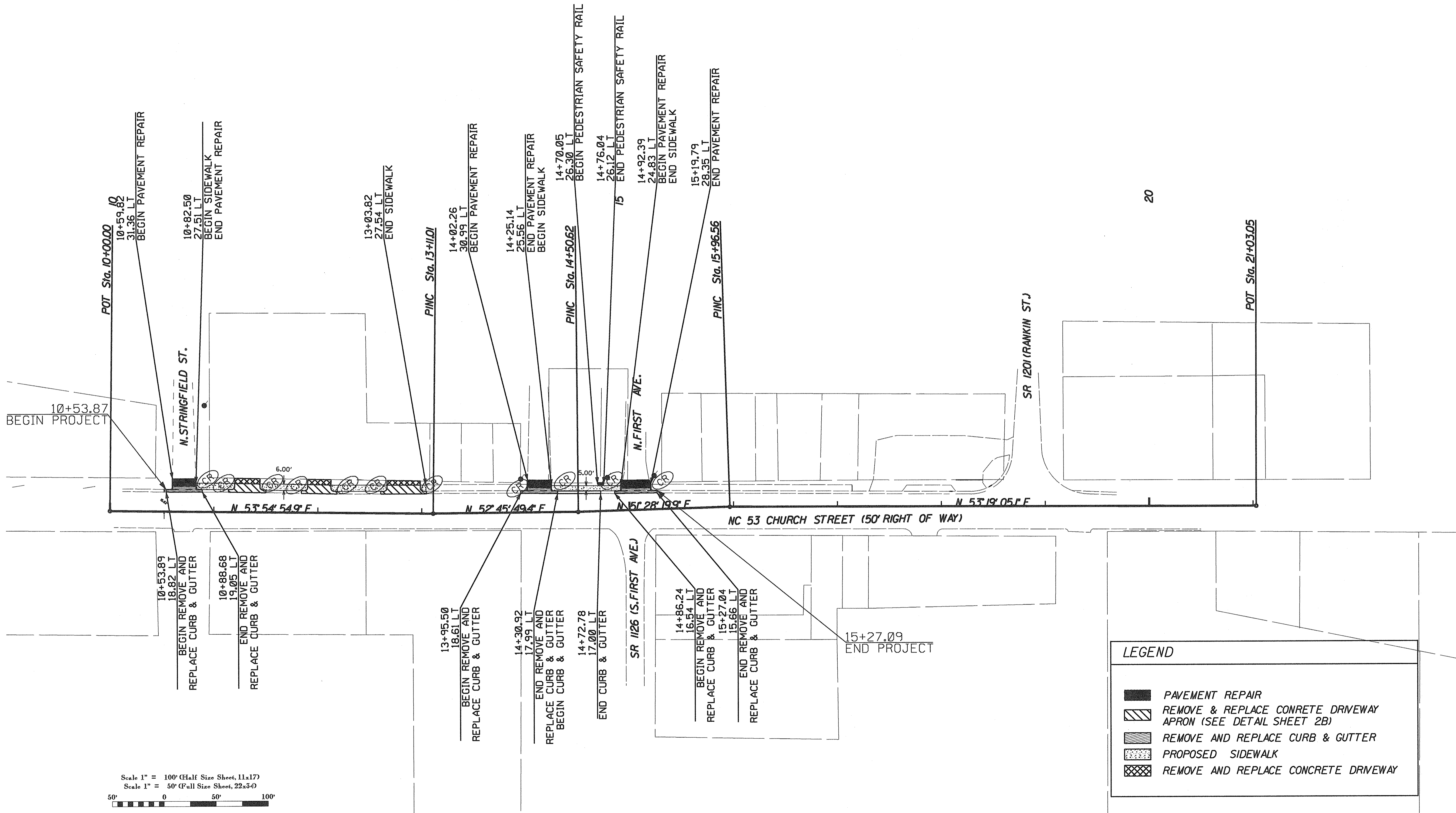

Scale 1" = 100' (Half Size Sheet, 11x17)
 Scale 1" = 50' (Full Size Sheet, 22x34)

LEGEND	
	PAVEMENT REPAIR
	REMOVE & REPLACE CONCRETE DRIVEWAY APRON (SEE DETAIL SHEET 2B)
	REMOVE AND REPLACE CURB & GUTTER
	PROPOSED SIDEWALK
	REMOVE AND REPLACE CONCRETE DRIVEWAY